

Lengüeta de tierra

Lengüeta de tierra

• Funciona para asegurar la conexión al sistema de tierra en el circuito.

Detalles técnicos.

Material: Bronce, latón niquelado, acero inoxidable

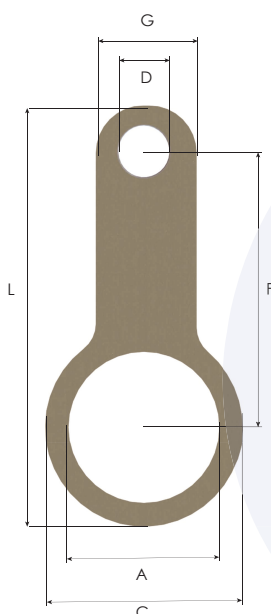

Tipo Métrica								
Para tamaño de rosca	Dimensiones							Numero de parte
	A mm	e mm	C mm	D mm	L mm	F mm	G mm	
M12	12.20	1.5	22.0	6.2	46.00	30.0	12.0	BMET02
M16	16.20	1.5	25.0	6.2	48.75	30.0	12.5	BMET01
M20	20.20	1.5	28.6	6.2	53.55	33.0	12.5	BMET1
M25	25.20	1.5	34.0	6.2	59.50	36.0	13.0	BMET2
M32	32.30	1.5	42.0	12.2	73.00	41.0	26.0	BMET3
M40	40.20	1.5	54.0	14.2	86.50	46.5	29.0	BMET4
M50	50.20	1.5	67.0	14.2	111.50	63.5	29.0	BMET5
M60	60.20	1.5	74.0	14.2	121.50	70.0	29.0	BMET60
M63	63.20	1.5	77.0	14.2	125.50	72.5	29.0	BMET6
M70	70.20	1.5	84.0	14.2	133.00	75.0	32.0	BMET70
M75	75.20	1.5	89.0	14.2	137.50	77.0	32.0	BMET7
M80	80.20	1.5	100.0	14.2	158.00	91.5	32.0	BMET80
M85	85.20	1.5	105.0	14.2	161.00	92.5	32.0	BMET85
M90	90.20	1.5	109.5	14.2	167.00	94.5	35.5	BMET8
M100	100.20	1.5	128.0	14.2	209.00	125.0	40.0	BMET9
M110	110.20	1.5	138.0	14.2	214.00	125.0	40.0	BMET10
M115	115.20	1.5	143.0	14.2	219.50	128.0	40.0	BMET115
M130	130.20	1.5	158.0	14.2	232.00	133.0	40.0	BMET130

Tipo NPT								
Para tamaño de rosca	Dimensiones							Numero de parte
	A mm	e mm	C mm	D mm	E mm	F mm	G mm	
NPT 1/4"	13.90	1.5	22.0	6.2	47.0	30.0	12.0	BNET02
NPT 3/8"	17.35	1.5	25.0	6.2	48.7	30.0	12.5	BNET01
NPT 1/2"	21.70	1.5	28.6	6.2	53.55	33.0	12.5	BNET1
NPT 3/4"	26.90	1.5	34.0	6.2	59.5	36.0	13.0	BNET2
NPT 1"	33.60	1.5	42.0	12.2	73.0	41.0	22.0	BNET3
NPT 1 1/4"	42.35	1.5	54.0	14.2	86.5	46.5	26.0	BNET4
NPT 1 1/2"	48.50	1.5	67.0	14.2	111.5	63.5	29.0	BNET5
NPT 2"	60.50	1.5	77.0	14.2	125.5	72.5	29.0	BNET6
NPT 2 1/2"	73.50	1.5	89.0	14.2	137.0	77.0	32.0	BNET7
NPT 3"	89.50	1.5	109.5	14.2	167.0	94.5	35.5	BNET8
NPT 3 1/2"	102.20	1.5	122.5	14.2	179.0	100.0	35.5	BNET9
NPT 4"	114.80	1.5	138.0	14.2	214.0	125.0	40.0	BNET10